

If this email is not displaying properly (e.g. if it's truncated or there are no pictures) then [click here to view this email in your web browser](#)

### 'ECONOMIC ANALYSIS' EXPOSED AS A SHAM



#### IN THIS NEWSLETTER:

1. [WEIGHING ONLY ONE SIDE](#)
2. [MOTOR RACING DELAYED, NOT CANCELLED](#)
3. [CONTROVERSY AS POPLAR TREES REMOVED](#)
4. [SECOND-BIGGEST PARK LANDS GIVEAWAY IN HISTORY](#)
5. [RAINBOW CIRCUIT - A SURVEY FOR YOU](#)
6. [MORE OUTDOOR EVENTS NEAR ADELAIDE OVAL](#)
7. [CONTACT A SENATOR - PARKS & SPECIES AT RISK](#)
8. [VIDEO OF THE MONTH - PARK 27 \(Bonython Park & more\)](#)
9. [SPORTS BUILDING BOOM](#)
10. [WHAT'S ON IN THE PARK LANDS](#)
11. [BRIEFLY, IN OTHER PARK LANDS NEWS](#)
12. [PHOTO OF THE DAY - RECENT HIGHLIGHTS](#)



#### 1. WEIGHING ONLY ONE SIDE

As we reported [in last month's newsletter](#), Premier Steven Marshall has refused to countenance ending a controversial State Government subsidy for the annual fossil fuel motor sport anachronism in Victoria Park / Pakapakanthi ([Park 16](#)).

As part of his response to APPA, the Premier claimed to be weighing both the positive and negative effects of a five-month Park Lands disruption against a four-day noisy motor festival.

*"I acknowledge the points you have raised regarding the disruption the event causes to the city. Of course, this matter must be weighed up against the significant economic impact the event brings to the race."*

Now, however, APPA can reveal that the Government has been "weighing" only one side of the ledger.



In 2018, the Government's hand-picked "Economic Research Consultants Pty Ltd" was tasked with measuring the benefit, to SA, of the four-day motor festival.

The South East City Residents Association spent 12 months trying to get access to the consultant's report. What they received eventually, via a Freedom of Information request, was heavily redacted. Almost half of the report that was released looks like this page 8:

[REDACTED]

[REDACTED]	[REDACTED]	[REDACTED]
[REDACTED]	[REDACTED]	[REDACTED]
[REDACTED]	[REDACTED]	[REDACTED]
[REDACTED]	[REDACTED]	[REDACTED]
[REDACTED]	[REDACTED]	[REDACTED]
[REDACTED]	[REDACTED]	[REDACTED]
[REDACTED]	[REDACTED]	[REDACTED]
[REDACTED]	[REDACTED]	[REDACTED]
[REDACTED]	[REDACTED]	[REDACTED]
[REDACTED]	[REDACTED]	[REDACTED]
[REDACTED]	[REDACTED]	[REDACTED]
[REDACTED]	[REDACTED]	[REDACTED]
[REDACTED]	[REDACTED]	[REDACTED]
[REDACTED]	[REDACTED]	[REDACTED]

[REDACTED]

[REDACTED]

[REDACTED]

[REDACTED]

[REDACTED]

[REDACTED]

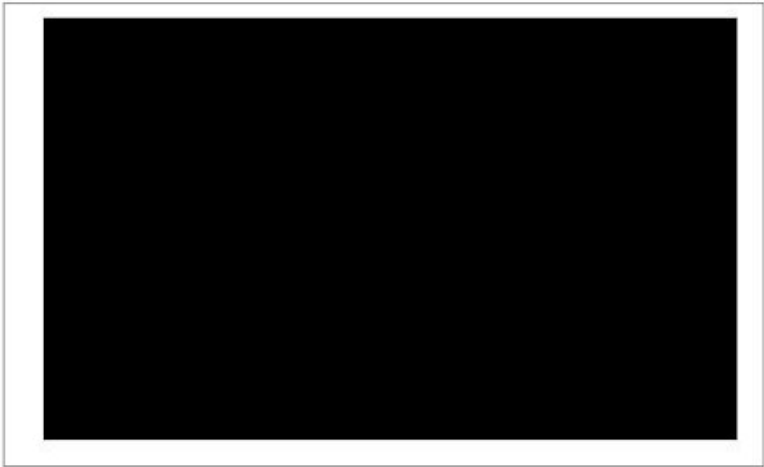

[REDACTED]

[REDACTED]

[REDACTED]

Nevertheless, it is clear even from the redacted report that the consultants made no attempt to measure the costs and disruption the community bears over the five month build and dismantle period, nor the impact of the event on the environment. Nor did the consultants attempt to quantify the damage to South Australia's "clean, green" tourism reputation caused by compromising the world's only city-encircling park over many months.

Rather, the focus of the so-called "weighing" was exclusively the short-term profit from a dwindling number of patrons who might otherwise have gone to watch motor sport at Tailem Bend.

**What can you do?**

A new "Adelaide 500" working group has been formed to campaign for an end to the annual motor sport takeover of Victoria Park, and its transfer to the purpose-built motor racing track at Tailem Bend. If you'd like to help the working group, contact [hendersonpauld@gmail.com](mailto:hendersonpauld@gmail.com)



**2. MOTOR RACING DELAYED, NOT CANCELLED**

In recent weeks, the Adelaide 500 motor race has had a minor setback, which has left its

advocates grasping for straws.

The event has been postponed from February to later in 2021 - in part because of the costs and time involved in assembling its temporary infrastructure, which might be affected by COVID-19 restrictions.



There has been a predictable backlash that because of the delay in 2021 "let's build a permanent grandstand and be done with it".

Even as support for fossil fuel usage evaporates, the Advertiser [has been promoting that opinion. \(\\$\\$ subscriber-only link\)](#)



Fortunately neither the Premier, Steven Marshall nor the Lord Mayor, Sandy Verschoor has backed such a divisive, short-sighted proposal.

Mr Marshall [has told APPA, in writing, that the State Government is not considering such a building.](#)

Ms Verschoor says a motor racing grandstand is not needed.

"There are many, many other users of that park" the Lord Mayor has told The Advertiser. "We have the criterium, solar cars, pedal prix, people walking dogs, people running ... that park should be for everyone."



Read the Lord Mayor's response to *The Advertiser* here (subscriber-only link (\$\$):  
<https://www.adelaidenow.com.au/messenger/city/adelaide-lord-mayor-against-victoria-park-grandstand-despite-superloop-500-loss/news-story/1160edf34c864c2267783bc5f2bbb1dd>

Meanwhile, pressure is growing to move the SuperCars event to Tailem Bend. The Premier has been promoting "The Bend" motor racing circuit as suitable even for Formula One cars. ([\\$\\$ subscriber-only link](#))

 Share  Tweet

### 3. CONTROVERSY AS POPLAR TREES REMOVED

Late in August, work crews moved in to remove this grove of white poplar trees from the southern end of Victoria Park / Pakapakanthi (Park 16).



This is the first step in creating a new wetlands area and rehabilitate the artificial drainage channel through the area (the South Park Lands Creek).



This was the scene of the former poplar grove last Thursday, 10 September.

With the poplars now gone, there is now a clear view of the eucalypt open woodland in the southern part of Victoria Park.



This is the vision of what is intended to replace the poplar grove.

These changes were proposed during a period of community consultation last year. Nevertheless the start of work in August alarmed some locals and those who had enjoyed the moody ambience of the poplar grove.

Among the cyclocross bicycle community the poplar plantation was nick-named "the Forest of Doom" and races were held, even in wet weather - something that will no longer be possible.



The poplar trees were planted in 1953, on the northern side of the South Park Lands Creek. At the time, the purpose of the plantation was merely to reduce localised flooding in winter. In the 1950's, the area was poorly regarded as a swamp.

However in recent years the 1953 plantation has been recognised as a mistake because poplars are known as an invasive species that have a negative effect on what might otherwise have been a thriving wetland area, with habitat for native species.



This scene (above) no longer exists.

The works in the area are intended to not only address localised flooding, but also reduce the risk of flooding downstream in Wayville, Goodwood and Unley. The project should also improve biodiversity and provide habitat for native species. This is an overview of what it might look like, assuming sufficient inflow to create the wetland:



Related work will occur later, in Blue Gum Park / Kurangga (Park 20). In that Park, some large trees will need to be removed along the course of the South Park Lands Creek, although new plantings are planned, to replace many of the trees targeted for removal.

Discussions are continuing between the City Council and the Brown Hill Keswick Creek Stormwater Project team, in an effort to minimise the loss of any significant native trees on the edge of the watercourse in Park 20.

You can read more about the project here: <https://dev.bhkcstormwater.com.au/>



#### 4. SECOND-BIGGEST PARK LANDS GIVEAWAY IN HISTORY

Formal "Expressions of Interest" have now closed for what will become the second-largest Park Lands giveaway in Adelaide's history.

The State Government is looking for private bidders to do it all, to **"design, finance, construct and own"** a massive new building on Park 11 within the world-unique, National heritage listed Adelaide Park Lands.





In return, the Government will simply hand over the land (within the former Royal Adelaide Hospital site) that is supposed to be held on trust as Park Lands, for the people of South Australia.

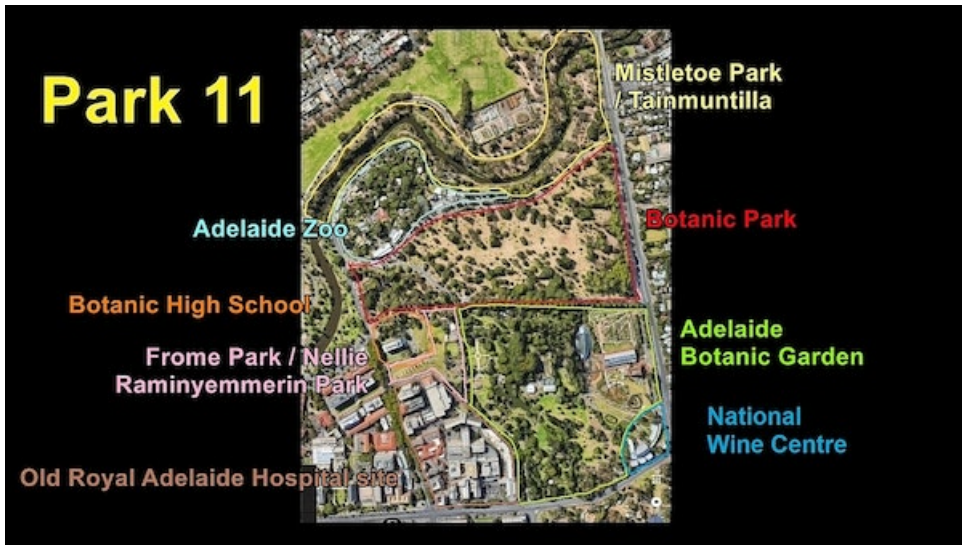

As scandals go, this is the second-biggest - surpassed only by the even larger and worse giveaway, to the Walker Corporation, of Festival Plaza, where construction of a 23-storey office tower is well under way. See the pic below, provided by Walker Corporation to *The Advertiser*.



Expressions of interest for the so-called "Lot Fourteen" (i.e. Park 11) site closed last Thursday, 10 September. Therefore we can expect to see, sometime soon, more artist's

impressions of soaring new buildings to be built on YOUR Park 11.

 Share  Tweet



### 5. RAINBOW CIRCUIT - A SURVEY FOR YOU

Support is growing for the proposed 'Adelaide Rainbow Circuit' - an uninterrupted illuminated, day-night cycling/walking/running trail around the Adelaide Park Lands.

The Premier, Steven Marshall recently referred the proposal to the State Treasurer to consider funding a feasibility study.



The project's founder, Jason Redman (pictured) now has a website for the Adelaide Rainbow Circuit, along with linked Facebook and Instagram feeds.

You can help by taking a 2-minute survey at the ARC website and/or following the ARC on Facebook. See the links at <https://www.adelaiderrainbowcircuit.com/>

#GetOnBoardTheARC

 Share  Tweet



### 6. MORE OUTDOOR EVENTS NEAR ADELAIDE OVAL

The City Council is expecting to see more community events staged in the gardens and lawns surrounding Adelaide Oval.

On Tuesday 8 September, [CHECK THIS ACTUALLY OCCURRED] the Council approved a consultation draft community land management plan for "the Adelaide Oval Precinct" which is the northern part of Tarntanya Wama ([Park 26](#)).

The Council retains very little control of this area. The State Government controls all of the area outlined in yellow and pink on the map below. The areas south of Adelaide Oval are still controlled by the City Council, but have been leased to Tennis SA (until 2057) and to Memorial Drive Tennis Club, and Next Gen fitness centre (until 2048).



Nevertheless, the proposed new City Council management plan envisages permitting:

- On Oval No. 2 - up to eight concerts or events each year, for crowds of up to 15,000 with amplified music
- On Creswell Gardens and/or Pennington Gardens West, community events (not commercial) with crowds of up to 5,000
- On Stella Bowen Park: community or cultural events with crowds of up to 1,500, during daylight hours.



Under the proposed plan, car parking will continue to be a major alienation in the Adelaide Oval Precinct area. There are already commercial arrangements for permanent car parks at Adelaide Oval, Memorial Drive Tennis Courts and the Next Gen fitness centre. See the pics above and below.

In addition, on "event days" the State Government allows the Stadium Management Authority to have up to 1,350 cars parked on Park Lands surrounding Adelaide Oval. The City Council

has no power to reduce this number.



The draft Community Land Management Plan will be distributed for public comment. Despite this "consultation", and regardless of any feedback, very little in the plan can be changed - because it largely just reflects the State Government's over-riding legal powers and the leasing and licensing arrangements that the State Government has already made with the Stadium Management Authority.



## 7. CONTACT A SENATOR - PARKS & SPECIES AT RISK

The Morrison Government is half-way through weakening what little federal legal protection exists for the Adelaide Park Lands and other sites of national environmental or heritage significance.

The "*Streamlining Environmental Approvals Bill*" was rushed through the House of Representatives late on Thursday 3 September, with the Government preventing independent MP's from debating the measures:

<https://www.abc.net.au/news/2020-09-03/australia-environment-laws-epbc-government-cross-bench/12627612>

The Bill will go before the Senate after Parliament resumes on 6 October.



The failings of Federal environmental protection have already been exposed by the Auditor-General:

<https://www.abc.net.au/news/2020-06-25/auditor-general-severe-deficiencies-environmental-protection/12393780>

In July, a landmark review into Australia's national environment laws called for a major overhaul, including establishing an "independent cop" to oversee them.

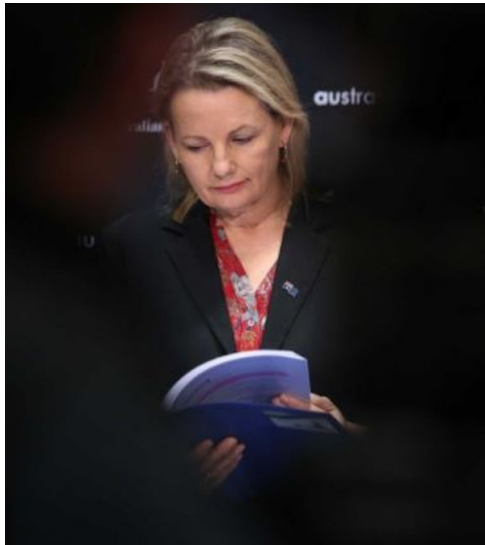

Environment Minister Sussan Ley (pictured) immediately rejected that option.

<https://www.abc.net.au/news/2020-07-20/epbc-act-environmental-review-report-recommends-independent-cop/12392594>

The "Streamlining Environmental Approvals Bill" would entirely remove federal oversight of what State Governments can do to threatened areas, habitats and species, that are supposedly protected by Federal legislation. The Adelaide Park Lands is just one of many sites at risk.

Environmental conditions across the world are rapidly deteriorating, due to climate change, land clearing, and developers targeting sensitive locations.

The challenges posed by COVID-19 make it more important than ever to protect our natural world - but the Federal Government is moving in the opposite direction, trying to strip away what little protection is offered by Federal laws.



It's now too late to contact your local MP to highlight this issue, because the vote in the House of Representatives has already been lost. The only recourse now is to contact one or more of South Australia's 12 senators:

**Liberal Party:**

- Alex Antic [senator.antic@aph.gov.au](mailto:senator.antic@aph.gov.au)
- Simon Birmingham [senator.birmingham@aph.gov.au](mailto:senator.birmingham@aph.gov.au)
- David Fawcett [senator.fawcett@aph.gov.au](mailto:senator.fawcett@aph.gov.au)
- Andrew McLachlan [senator.mclachlan@aph.gov.au](mailto:senator.mclachlan@aph.gov.au)
- Anne Ruston [senator.ruston@aph.gov.au](mailto:senator.ruston@aph.gov.au)

**ALP**

- Don Farrell [senator.farrell@aph.gov.au](mailto:senator.farrell@aph.gov.au)
- Marielle Smith [senator.marielle.smith@aph.gov.au](mailto:senator.marielle.smith@aph.gov.au)
- Alexander Gallacher [senator.gallacher@aph.gov.au](mailto:senator.gallacher@aph.gov.au)
- Penny Wong [senator.wong@aph.gov.au](mailto:senator.wong@aph.gov.au)

**Centre Alliance**

- Stirling Griff [senator.griff@aph.gov.au](mailto:senator.griff@aph.gov.au)

**Greens**

- Sarah Hanson-Young [senator.hanson-young@aph.gov.au](mailto:senator.hanson-young@aph.gov.au)

**Independent**

- Rex Patrick [senator.patrick@aph.gov.au](mailto:senator.patrick@aph.gov.au)

Given the well-known public positions of each of the major parties and the Greens, it is probably most important to contact the two Senators who might be undecided, i.e. the two Centre Alliance and Independent senators. Clicking on each of the links above will open up a suggested draft email for you to use.



## 8. VIDEO OF THE MONTH - PARK 27 (Bonython Park & more)

Our video for September looks at a Park that has lost so much - but still has, at its core, one of the most popular parts of the Adelaide Park Lands.

**Park 27** includes Bonython Park / Tulya Wardli but that is only one part of its story.



Next month: John E. Brown Park (**Park 27A**).

Catch up with videos for most of the other Parks (Park 1 through to Park 26) [at our YouTube Channel](#).



## 9. SPORTS BUILDING BOOM

### a) Lutheran Sports Club - Park 21W

The City Council has approved in principle yet another private function centre on the Park Lands. The Lutheran Sports Club put forward a design for a two-storey building in Golden Wattle Park / Muirmu Wirra (**Park 21W**).

In addition to change rooms, toilets and other facilities for sport, the building design also includes a second floor massive "multi-purpose space" - with seating capacity for 150 (see the area on the left in the plan, below).

If constructed it would more than double the floor space of the current sports building in that Park - from 350 square metres to 895 square metres.

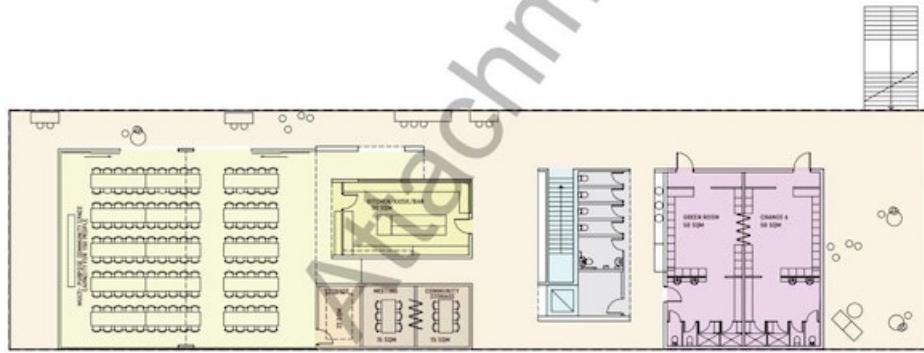

There is not yet any funding available for construction of this building, but now that the Council has approved the design, the sports club will be looking for funding.

The Council ignored **APPA's submission that private social spaces or clubrooms should not be located on public Park Lands.**

### b) Prince Alfred College - Park 9

In **last month's newsletter we reported** that the Adelaide Park Lands Authority had deferred plans by Prince Alfred College and its Old Collegians for a multi-million dollar sports building and "club rooms" on Bunday's Paddock / Tidlangga (**Park 9**).



The story's now been taken up **in the Adelaide Review**.

Author John Bridgland has put this proposal into the context of several recent other proposals (and others still in the pipeline). He draws attention to recent trends for ever-larger buildings, containing function rooms and catering facilities, needing larger car parks on Park Lands and with sporting bodies wanting ever-longer leases at heavily discounted rates.

Read the story here:

<https://www.adelaidereview.com.au/latest/news/2020/09/03/elite-school-building-bid-prompts-park-lands-probe/>



## 10. WHAT'S ON IN THE PARK LANDS

There are always events scheduled in the Park Lands, many of them free, and there are always opportunities to explore the Park Lands on your own, or with friends or family. Browse our **Explore Parks** pages for hints about interesting spots to visit.

Here are just some of the opportunities in coming weeks:

### Adelaide Marathon Festival



Sunday 20 September from 6am at Pinky Flat (**Park 26**). Click the pic for details



#### Adult Learn to Ride or 'Back on the Bike'

20 & 27 Sept. 1:45 to 4:00pm at GS Kingston Park / Wirraminithi (**Park 23**).

Free event, but bookings required Click the pic for details.



#### South Parklands, Nature by night

Monday 28 September 6.30 to 7.30pm  
Pelzer Park / Pityarilla (**Park 19**)

Free event, but bookings required.  
Click the pic for details



#### Come 'n' try Bush Care

Multiple dates, starting Wednesday 30 September, 10.00am to 1.00pm in the South Park Lands

Free event, but bookings required  
Click the pic for details



#### The In-TREE-guing Trail

a gentle 19km bike ride around the Park Lands. Sunday 27 September 10am to 3pm.  
Tickets \$5. Click the pic for details and/or to book.

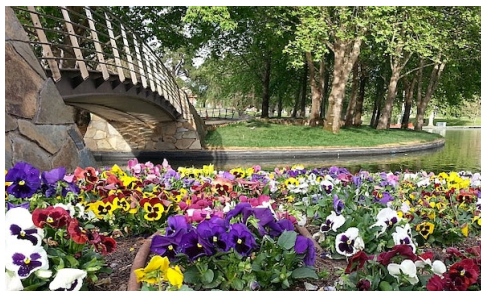

#### Guided walk through Rymill Park / Murlawirrapurka (**Park 14**)

Sunday 11 October 10.00 to 11.30am  
Click the pic for details and/or to book

[f Share](#) [T Tweet](#)

## 11. BRIEFLY, IN OTHER PARK LANDS NEWS



## Auditor-General warns on Oval Hotel

We hate to say "We told you so" to the Government, but of course we did warn about this.

As reported in InDaily earlier this month:

*"The State Government did not follow "specialist advice" on the rate of its Adelaide Oval Hotel loan because it "may not be commercially viable", the Auditor-General has found, in a report warning the coronavirus pandemic's ongoing impact on the stadium's operations "may present a risk" to its ability to fulfil its loan obligations."*



Read the InDaily story here: <https://indaily.com.au/news/2020/09/02/govt-was-warned-adelaide-oval-hotel-loan-may-not-be-viable/>

This was just one of the 28 reasons that we gave to the Government in our efforts to prevent this commercial assault on Park 26. See the other 27 reasons here: [www.adelaide-parklands.asn.au/oval-hotel](http://www.adelaide-parklands.asn.au/oval-hotel)

---

## New light towers in Park 25

Four new 30-metre light towers have been installed at Karen Rolton Oval, in Gladys Elphick Park / Narningga (**Park 25**) off Port Road opposite the Royal Adelaide Hospital.



This is only one of many sporting fields within the Park Lands that are floodlit for night sport.

Karen Rolton Oval in [Park 25](#) is fenced but is available for public use when it's not being used by the licencees: SA Cricket Association or Old Ignatians Football Club.

You can find out more about this Park on our Guided Walk in [Park 25](#), on Sunday 27 September. See the "What's On" segment above.

---

**Art Prize brief here**

APPA is preparing for the long-awaited exhibition of finalists in the Adelaide Park Lands Art Prize. After being delayed earlier this year due to COVID-19 restrictions, an exhibition of the 77 finalists' works is due to appear at the Adelaide Festival Centre from 4 December 2020 to 30 January 2021.

You can purchase artworks even before the exhibition opens. Purchased artworks will be on display in the exhibition. Purchasers will be able to collect them after the exhibition concludes on 30 January 2021.



Pictured above: four of the 77 finalists. Clockwise from top left:

- **William Simson - "Rainbow Catcher"** Mixed media on wood
- **Jason McDonald - "Yellow, Tailed Black Cockatoo and River Sheoak"** Photography
- **Harriet North - "The Colour and Wings of Adelaide"** Embroidery threads
- **Danny Jarratt - "The Garden"** Digital painting

To artworks from the coming exhibition, visit: [www.parklandsart.com](http://www.parklandsart.com)

### 'Green time' counteracts 'screen time'

Time spent outdoors in natural places such as the Adelaide Park Lands can be an antidote to long hours in front of TV, computers or playing video games.

Adelaide University research suggests the positive effects of time surrounded by nature can boost academic performance, wellbeing and mental health.



Read the full story here: <https://www.kidsnews.com.au/health/time-outdoors-is-good-medicine-for-hitech-kids/news-story/aa0581bcd49506df4a56b5fa2a4d8365>

### Tent village in Park 23

Camping or makeshift housing on the Park Lands resurfaces as an issue from time to time. During the Great Depression of the 1930s there were many shanty huts erected in Park 11, and isolated tents are found fairly frequently.

In late August and early September 2020, at least a dozen tents were set up just off West Terrace in G.S. Kingston Park / Wirrarinthi (**Park 23**). It was the largest such campsite seen in recent decades. However by Friday 11 September, many of the tents had gone, and only six remained:



There is a City Council by-law that prohibits camping. However, the City Council is not obliged to enforce this by-law. It can exercise discretion and leave such campsites undisturbed. In practice, homeless people are usually referred to welfare shelters.

### Join us!

You can be a proud Park Lands supporter, with membership starting at only \$15 (for concession and student membership) expiring 30 June 2021. Longer-term memberships are also available.

We rely almost exclusively on annual membership fees to continue our Park Lands advocacy, so if you haven't already, please consider putting your money where your mouth is and backing APPA to keep up the Park Lands fight.

Join here: [www.adelaide-parklands.asn.au/membership](http://www.adelaide-parklands.asn.au/membership)

As a financial member of APPA, you receive:

- the priceless satisfaction of supporting APPA's work;
- free participation in our [monthly guided Park Lands walks](#);
- eligibility to become a Park Ambassador and lead an annual [guided walk through one Park](#);
- the responsibility to help guide APPA's activities through the [Annual General Meeting](#);
- the opportunity to join the APPA Managing Committee;
- a printable PDF membership certificate (as below).



For existing members, renewal invitations were sent out during June and July.

### Help Us Keep the Bastards Honest



This is the era of "fake news". It is so easy for anyone to disseminate lies and misinformation. Traditional media outlets (newspapers, TV and radio) have dwindling resources for gathering news or fact-checking dubious claims.

In this environment, APPA's role as a community watchdog has never been more important. We publish regularly on our website and social media, and also (especially) in this monthly newsletter, where we regularly break news. We cover both positive and negative stories, being both proactive and reactive to communicate what's happening IN the Park Lands and TO the Park Lands. But we need help to carry out this vital work.

Our small publication team needs a hand - two volunteer journalists-cum-editors to assist in the regular task of getting out this newsletter every month. Time commitment

negotiable. Contact [secretary@adelaide-parklands.asn.au](mailto:secretary@adelaide-parklands.asn.au) to express your interest.



## 12. PHOTO OF THE DAY - RECENT HIGHLIGHTS

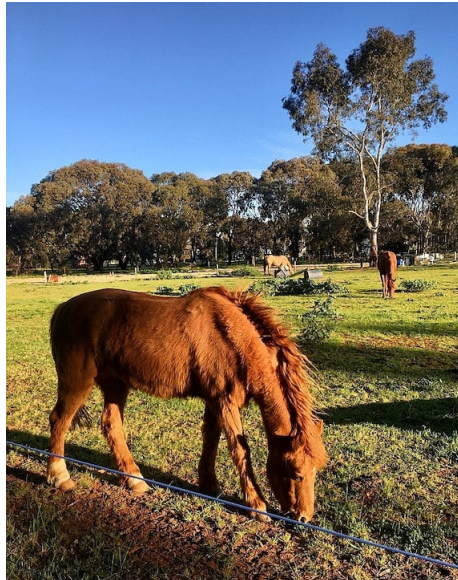



From the top:

- Wood duck family and human family both enjoying the sunshine in Veale Gardens, Veale Park / Walyu Yarta ([Park 21](#))
- Pelican and picnickers on the Torrens Riverbank in Red Gum Park / Karrawirra ([Park 12](#)). Pic: Fiona Caulfield @love\_travel\_australia
- Cleo and Gaia (rescue dogs) in G.S. Kingston Park / Wirrarninthi ([Park 23](#)). Pic: @blackeyedsis
- Walking past the wattle in Golden Wattle Park / Mirnu Wirra ([Park 21W](#))
- Horses in Lefevre Park / Nantu Wama ([Park 6](#)). Pic: Tony Sinclair @tony\_of\_adelaide
- Clivea and Moreton Bay fig tree in the Adelaide Botanic Garden, part of [Park 11](#)

The Park Lands "photo of the day" series has been running since May 2014, and the collection of Park Lands photos gathered over more than six years now numbers over 2,300.

We maintain (and gradually grow) more than 40 separate albums: one for each numbered Park and Square, along with several albums for "Alienations".

Contributions are very welcome! To find out more about any of these featured Parks, click the link to the Park number.

To see the #AdelaideParklands #picoftheday as it's released each morning, just [follow us on Facebook](#), [Instagram](#) &/or [Twitter](#).

Despite being a National Heritage-listed place, the Adelaide Park Lands are not well protected by Federal environmental laws.

That's why we've joined the [Places You Love Alliance](#), to campaign along with 56 other organisations for better environmental protection laws.



**PLACES  
YOU  
LOVE**

**BETTER LAWS  
FOR A  
BETTER PLANET**

#### **NEWSLETTER TEAM**

Editor: Shane Sody  
Contributors: Ted Jennings, Kate Treloar  
Proofreader: Trish Russell

Send content enquiries/submissions to [secretary@adelaide-parklands.asn.au](mailto:secretary@adelaide-parklands.asn.au)

Here at APPA, we hate marketing (spam) emails. That's why we deliver news about the Park Lands, in this email format, only once per month. If you're after more regular information, please [follow us on Facebook](#) where we are posting every day.

Unlike marketing emails, we're not trying to sell you anything, so we hope you'll forgive this intrusion to your InBox.

Nevertheless, if you'd rather not hear from us in future, you can [unsubscribe here](#).